



Long Cable Testing

This article describes how to test very long cables. The standard autotest is supported by the TestPro up to 600m. There is also a special test mode for cables from 500m to 1000m in length. These situations are becoming more common with the growth in Cat 3 IoT and low speed building automation applications.

1. Press Settings

From the home screen, press the Project softkey

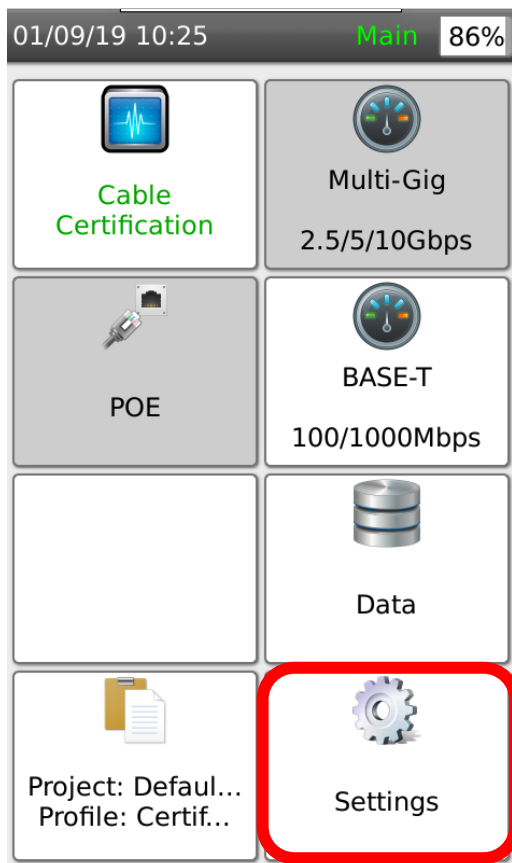

2. Press Certifier/Validator Settings

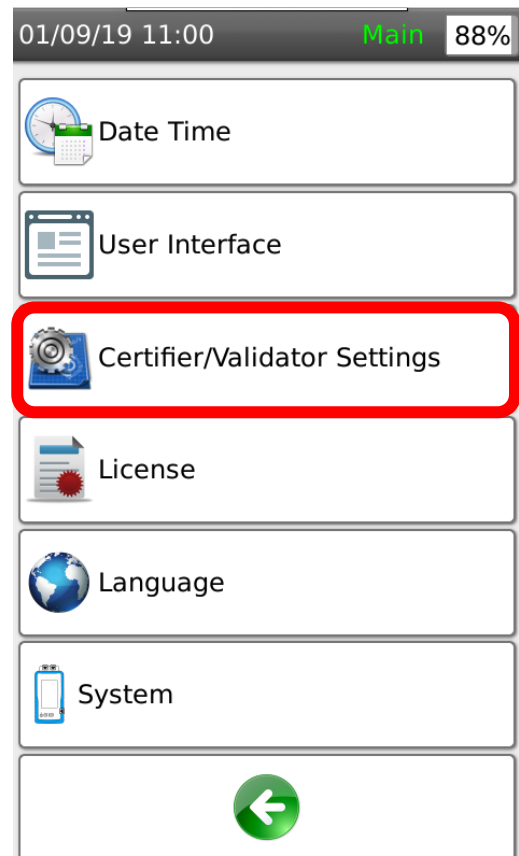

3. Select "Long Cable"

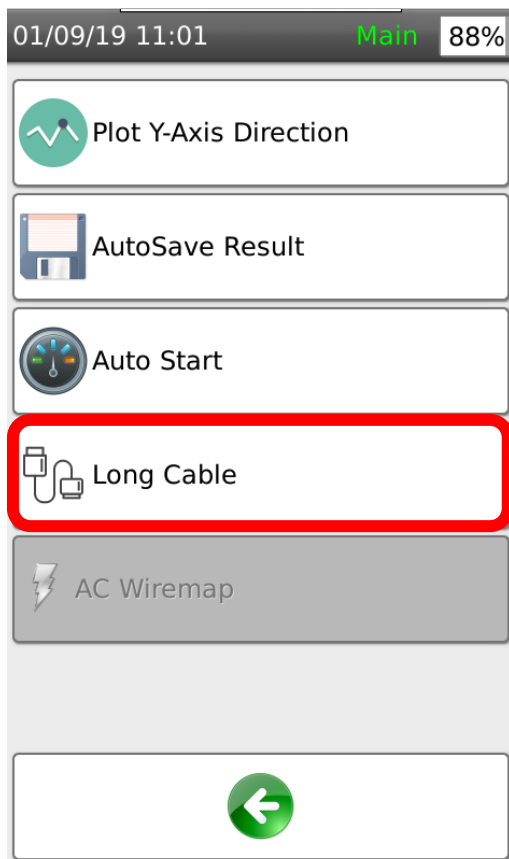

4. Press Limit

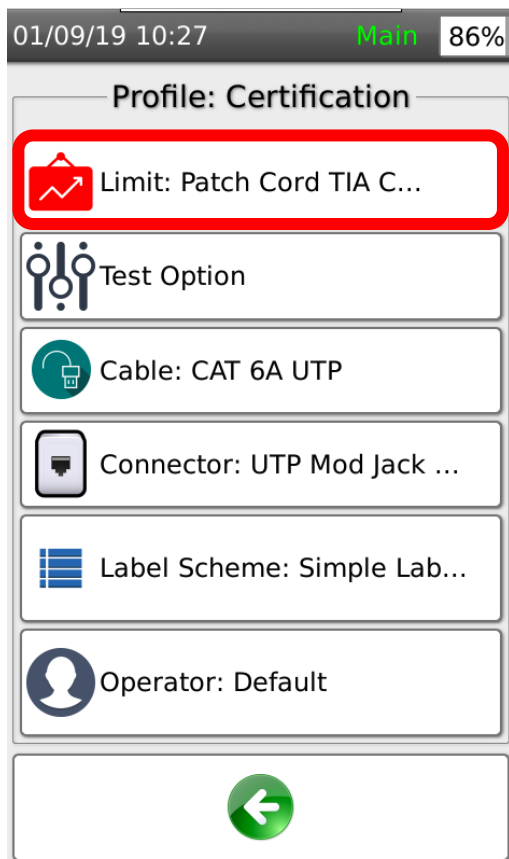

5. Press Enter.

Then press return until you get to the main screen

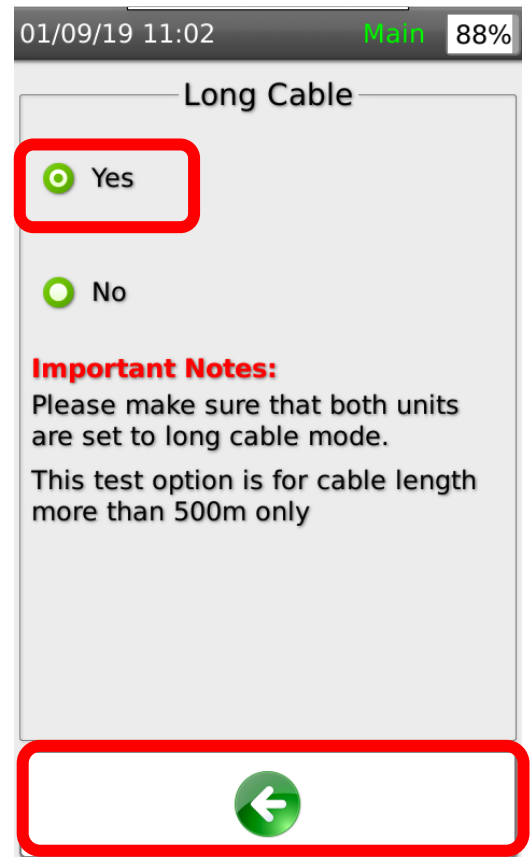

6. Repeat this process for the Remote unit as well

7. Press Cable Certification

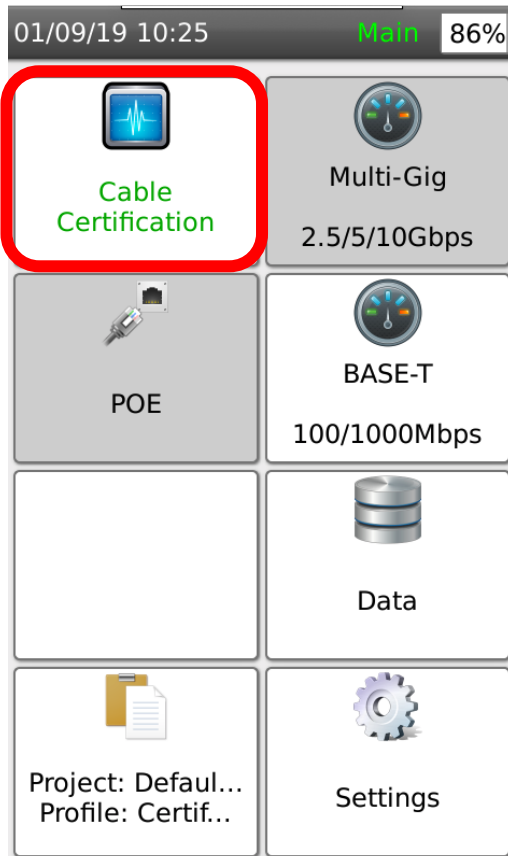

9. Results are displayed



8. Press Autotest

